

# Mounting Dimensions for KS Flanges

## Anbaumaße für KS-Flansche

Internal spindle contour for  
Adaptor Flange KS 20

Spindelinnenkontur für  
Vorsatzflansch KS 20

Size / Größe	32	40	50	63	80	100
Module Size						
Modul Bau-Größe D1	60	70	80	100	117	140
D2 ± 0,1 [mm]	44	53	63	79	96	119
D3 <sup>F8</sup> [mm]	30	35	40	50	60	80
D4 [mm]	31	36	41	51	61	81
D5 [mm]	4,5	5,0	5,0	5,0	6,0	6,0
L1 [mm]	12	12	12	14	14	14
L2 [mm]	7	7	7	8	8	8
G1 [mm]	M5	M6	M6	M8	M8	M10
G2 [mm]	M8x1	M8x1	M8x1	M10x1	M10x1	M10x1
T [mm]	11	14	14	15	15	18
T1 +0,5 [mm]	3	3,5	3,5	3,5	4,5	4,5

Internal spindle contour for  
Mounting Flange KS 21

Spindelinnenkontur für  
Einbaufansch KS 21

Size / Größe	32	40	50	63	80	100
D1	55	63	80	100	117	140
D2 ±0,1 [mm]	42	50	63	79	96	119
D3 H7 [mm]	13	15	18	20	23	29
D4 F8 [mm]	28	35	44	56	68	88
D5 [mm]	22	25	31	35	43	55
D6 +0,2 [mm]	28,2	35,2	44,2	56,2	68,2	88,2
D7 [mm]	4,5	5,0	5,0	5,0	6,0	6,0
E [mm]	0,4 x 0,2	0,4 x 0,2	0,6 x 0,3	0,6 x 0,3	0,6 x 0,3	0,6 x 0,3
L1 +0,1 [mm]	15,2	18,2	21,2	25,2	33,2	43
L2 min. [mm]	24	27	30,5	35,5	43,5	57
L3 [mm]	7	7	7	8	8	8
F [mm]	1,0	1,0	1,0	1,5	1,5	1,5
G1	M5	M5	M8x1	M10x1	M10x1	M10x1
G2	M4	M5	M8x1	M10x1	M10x1	M10x1
T [mm]	11	14	14	15	15	20
T1 +0,5	3	3,5	3,5	3,5	4,5	4,5

Internal spindle contour for  
Mounting Flange for  
short spindles KS 22

Spindelinnenkontur für  
Einbaufansch für  
Kurzspindeln KS 22

Size / Größe	32	40	50	63
D1	40	50	63	80
D2 ±0,1 [mm]	33	41	52	66
D3 <sup>H7</sup> [mm]	13	15	18	20
D4 <sup>F8</sup> [mm]	28	35	44	56
D5 [mm]	22	25	31	35
D6 +0,2 [mm]	28,2	35,2	44,2	56,2
D7 [mm]	4,0	4,5	5,0	5,0
E [mm]	0,4 x 0,2	0,4 x 0,2	0,6 x 0,3	0,6 x 0,3
L1 +0,1 [mm]	16,2	18,2	19,2	22,2
L2 min. [mm]	25	27	29	32,5
L3 [mm]	5,5	6	7	8
F [mm]	1,0	1,0	1,0	1,5
G1	M3	M4	M5	M6
G2	M4	M5	M6	M8x1
T [mm]	10	13	15	16
T1 +0,5	3	3,5	3,5	3,5

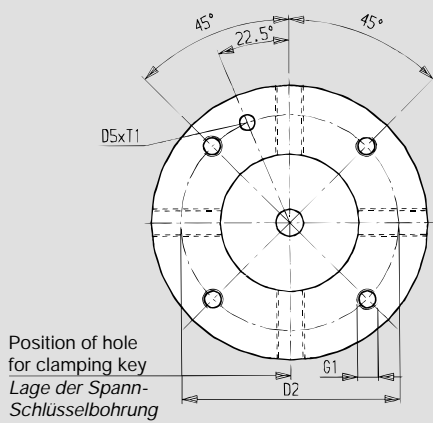

Position of hole for clamping key  
Lage der Spannschlüsselbohrung

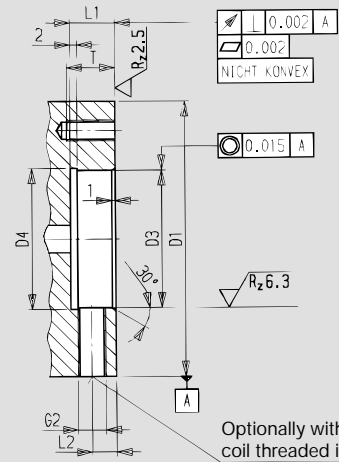

Optionally with Heli-coil threaded insert  
Wahlweise mit Heli-coil Gewindeeinsatz

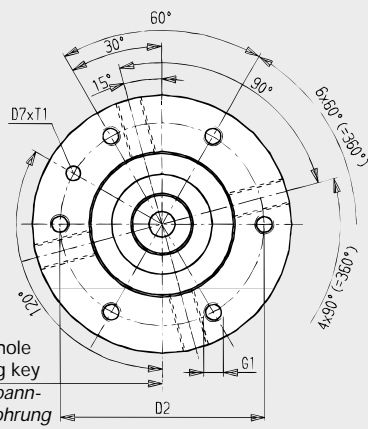

Position of hole for clamping key  
Lage der Spannschlüsselbohrung

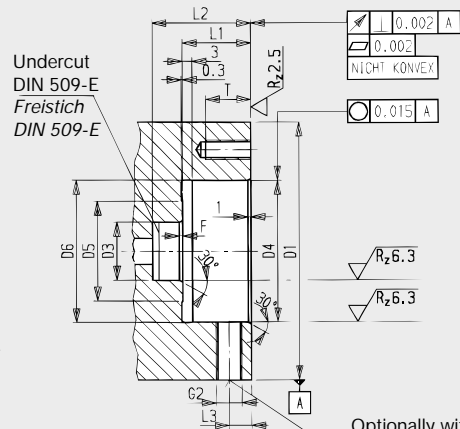

Optionally with Heli-coil threaded insert  
Wahlweise mit Heli-coil Gewindeeinsatz

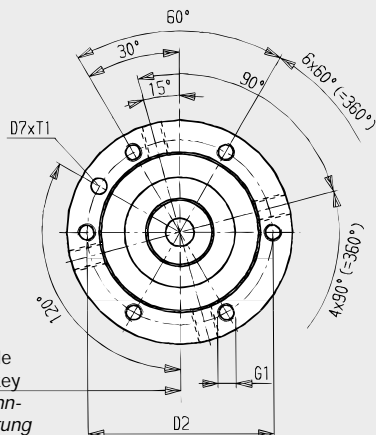

Position of hole for clamping key  
Lage der Spannschlüsselbohrung

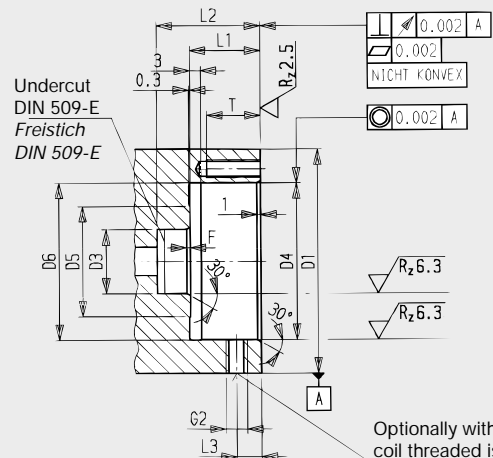

Optionally with Heli-coil threaded insert  
Wahlweise mit Heli-coil Gewindeeinsatz